

# 4G CPE 3 Product FAQs

# 1 Modify the IP address of the WAN/LAN port

The IP address of the WAN port is automatically obtained from the upstream network and cannot be changed, except for the static IP mode, which needs to obtain the IP address from the carrier. The IP address of the LAN port can be changed as follows:

1. Connect your computer to the CPE's Wi-Fi (or to the CPE's LAN port using an Ethernet cable). Enter 192.168.8.1 in the address box of the browser, and enter the login password to access the management page of the CPE.
2. Go to **Advanced > Router > DHCP**. In the **LAN IP address** field, enter the new IP address, and click **Save**. To access the web-based management page, enter the new IP address in the address bar of a browser.

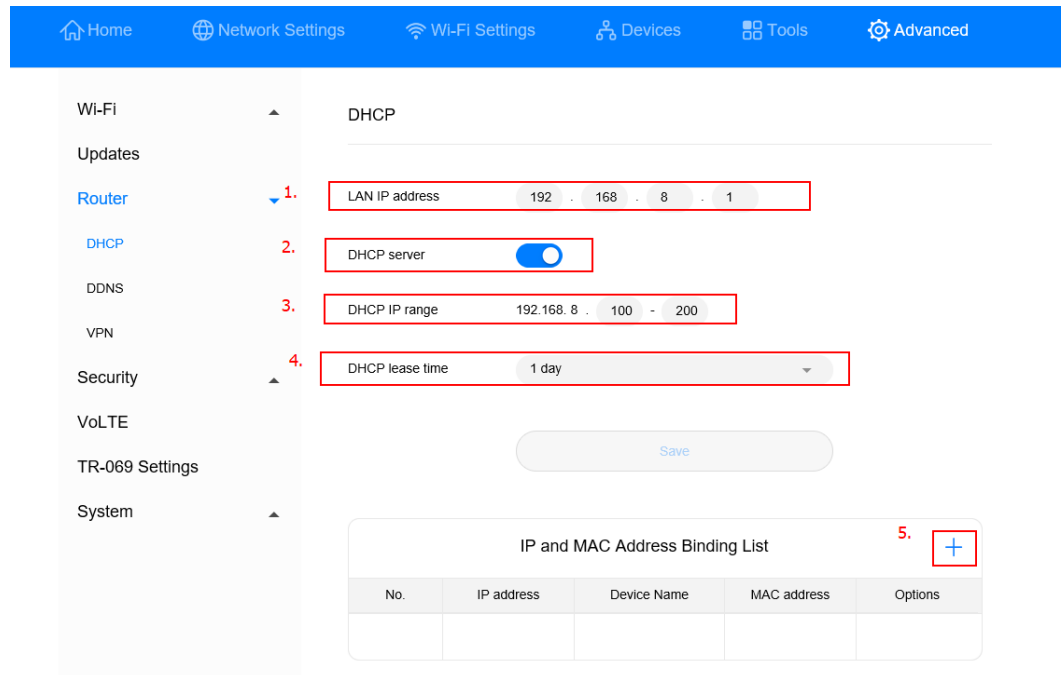

3. To change the network segment of the IP address pool, for example, from 192.168.8.\* (\* ranges from 100 to 200 by default) to 10.10.10.\* (\* ranges from 100 to 200 by default), you can directly change **LAN IP address** to 10.10.10.1. In this case, the **DHCP IP range** is automatically changed to 10.10.10.100–10.10.10.200. You can also manually change **DHCP IP range** to a value ranging from 10.10.10.2 to 10.10.10.254.

If you only want to change the value of \* in 192.168.8.\*, you can directly change the start and end IP addresses in **DHCP IP range**.

# 2 Disable or enable Wi-Fi

---

1. Connect your computer to the CPE's Wi-Fi (or to the CPE's LAN port using an Ethernet cable). Enter **192.168.8.1** in the address box of the browser, and enter the login password to access the management page of the CPE.
2. Go to **Wi-Fi Settings > Wi-Fi Basic Settings**, check **Wi-Fi**, then click **OK** in the displayed dialog box to disable Wi-Fi. If the checkbox next to **Wi-Fi** turns blue, it indicates that Wi-Fi is enabled. Wi-Fi is enabled by default.

 **NOTE**

- To enable Wi-Fi again, connect your computer to the LAN port of the CPE using a network cable, and then log in to the web-based management page to enable Wi-Fi. It is recommended that you keep Wi-Fi enabled.
- After the CPE is restored to factory settings, Wi-Fi is automatically enabled. However, all configuration parameters are cleared after the restoration. In this case, you will need to set the parameters again.

# 3 Set the Wi-Fi encryption mode of the CPE

1. Connect your computer to the CPE's Wi-Fi (or to the CPE's LAN port using an Ethernet cable). Enter **192.168.8.1** in the address box of the browser, and enter the login password to access the management page of the CPE.
2. Go to **Wi-Fi Settings > Wi-Fi Basic Settings**, expand the **Security mode** drop-down list box, select the required mode, and click **Save**.

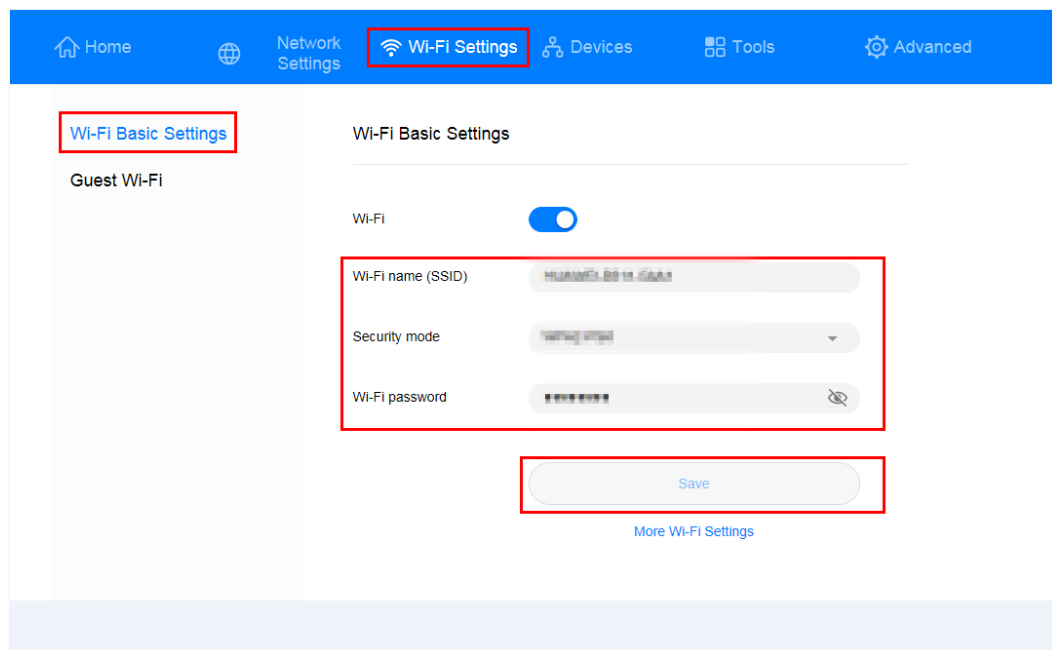

# 4 Set the dynamic domain name system

1. Connect your computer to the CPE's Wi-Fi (or to the CPE's LAN port using an Ethernet cable). Enter **192.168.8.1** in the address box of the browser, and enter the login password to access the management page of the CPE.
2. Go to **Advanced > Router > DDNS**. Click **Add DDNS**, enter the **Domain Name**, **User name**, and **Password** provided by the carrier, and click **Save**.

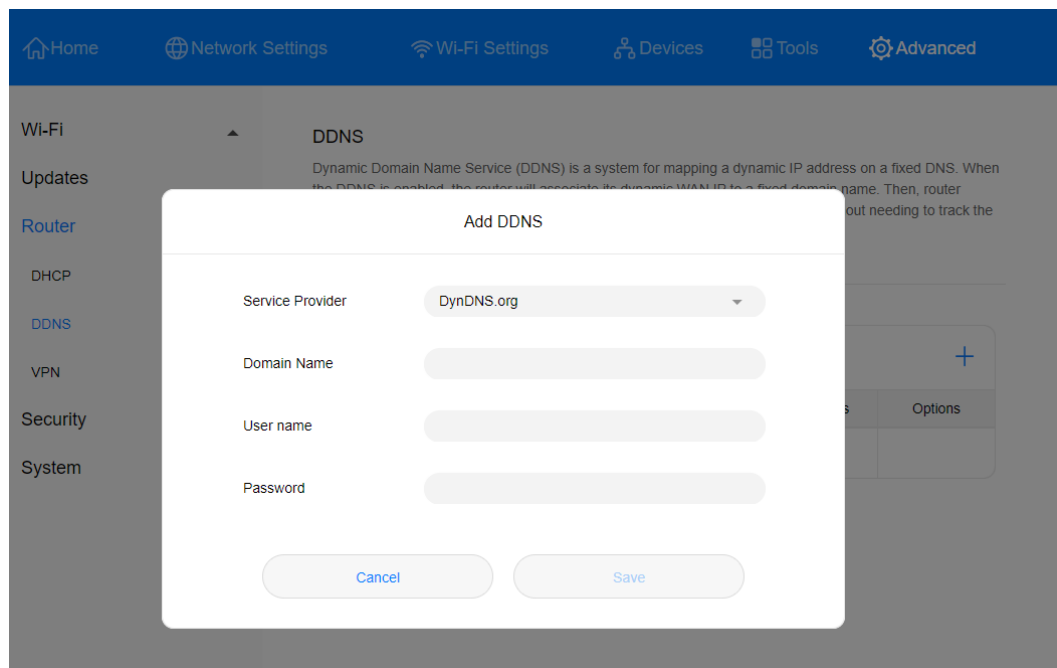

## NOTE

Consult your carrier if you have any queries about the **Domain Name**, **User name**, and **Password**.

# 5 Enable or disable the firewall

1. Connect your computer to the CPE's Wi-Fi (or to the CPE's LAN port using an Ethernet cable). Enter **192.168.8.1** in the address box of the browser, and enter the login password to access the management page of the CPE.
2. Go to **Advanced > Security > Firewall** and check **Enable firewall** to enable the firewall function, or uncheck **Enable firewall** to disable the firewall.

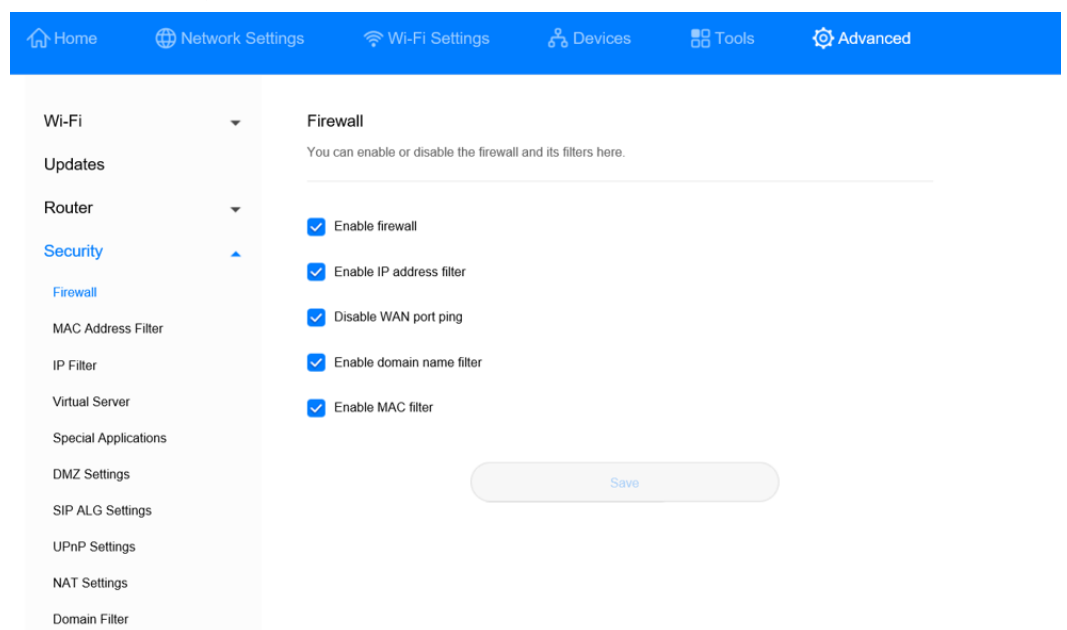

# 6 Set the mobile data limit

1. Connect your computer to the CPE's Wi-Fi (or to the CPE's LAN port using an Ethernet cable). Enter **192.168.8.1** in the address box of the browser, and enter the login password to access the management page of the CPE.
2. Go to **Tools > Statistics**, and click  .

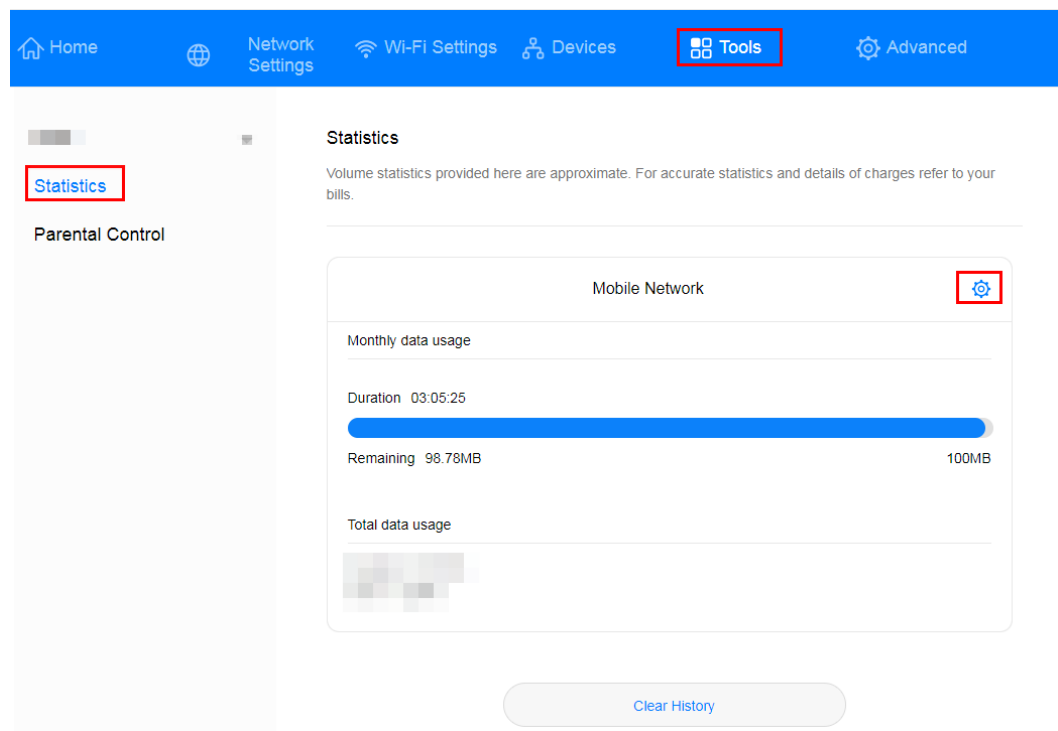

3. Set the upper data limit and click **Save**.



### Mobile Network

---

Set monthly package

Start date 1 ▾

Monthly data plan 1 GB ▾

Threshold 90 %

CancelSave

 **NOTE**

Your device will not disconnect from the Internet after the data usage reaches the limit you set, but will only notify you that the data usage has exceeded the limit. Additional charges may apply if you continue consuming data.

# 7 Change the login password

1. Connect your computer to the CPE's Wi-Fi (or to the CPE's LAN port using an Ethernet cable). Enter **192.168.8.1** in the address box of the browser, and enter the login password to access the management page of the CPE.
2. Go to **Advanced > System > Modify Password**, enter the **Current password**, **New password**, and **Confirm password**, and click **Save**.

The screenshot displays the CPE management interface. At the top, a blue navigation bar contains icons for Home, Network Settings, Wi-Fi Settings, Devices, Tools, and Advanced (highlighted with a red box). On the left, a sidebar menu lists various settings categories: Wi-Fi, Updates, Router, Security, System (highlighted with a red box), Device Information, Restart, Reset, Diagnosis, Modify Password (highlighted with a red box), PIN Code Management, Time Settings, and System Settings. The main content area is titled 'Modify Password' and includes a warning: 'Changing the login password frequently prevents unauthorized users from modifying configurations.' Below this, there are three input fields: 'Current password', 'New password', and 'Confirm password', all highlighted with a red box. A 'Save' button is positioned below the input fields, also highlighted with a red box.

# 8 Configure the virtual server

1. Connect your computer to the CPE's Wi-Fi (or to the CPE's LAN port using an Ethernet cable). Enter **192.168.8.1** in the address box of the browser, and enter the login password to access the management page of the CPE.
2. Go to **Advanced > Security > Virtual Server**, and click the **+** icon to access the virtual server configuration page.

Virtual Server

Configure a virtual server to enable external computers to access WWW, FTP or other services provided by the LAN.

[Help](#)

IP address: Designate a computer locates at the LAN to provide services.  
LAN/WAN port: Computer port for the virtual server whose range is 1-65535.  
Protocol: Protocols applied by services.

Virtual Servers List							+
Name	WAN Port	LAN IP Address	LAN Port	Protocol	Status	Options	

3. Enter **Name**, **Protocol**, **WAN Port**, **Device**, **LAN IP Address**, and **LAN Port**, and click **Save** to complete configuration.

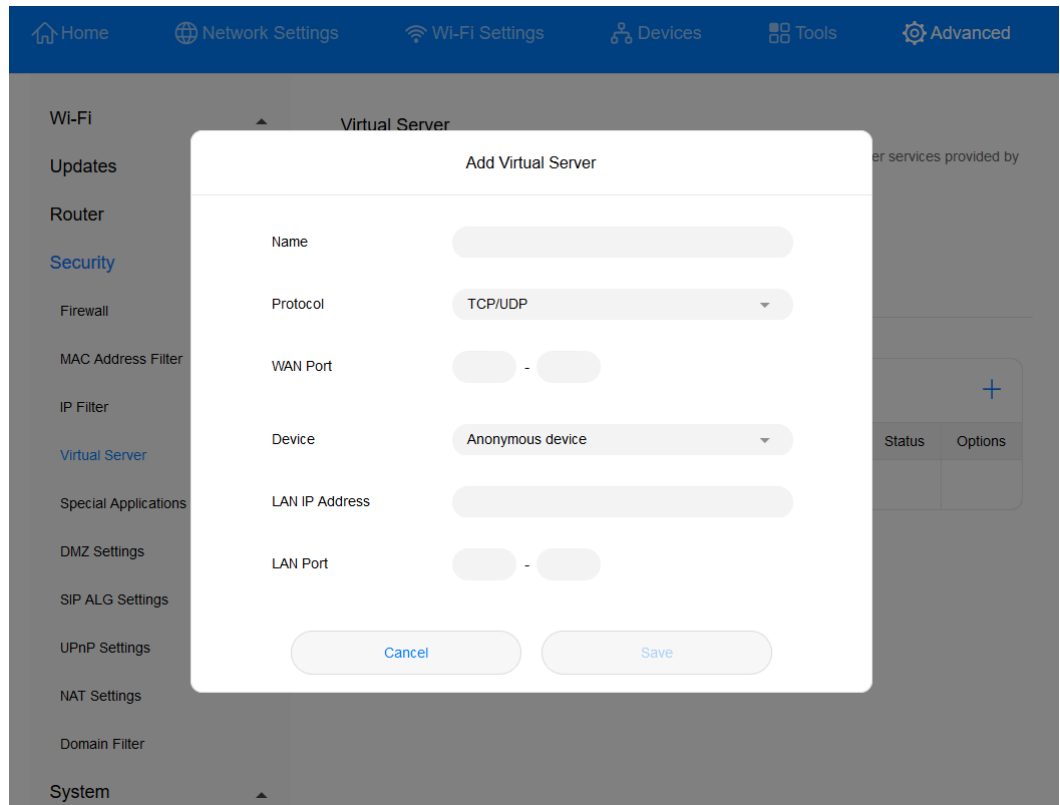

**NOTE**

A maximum of 32 virtual servers can be configured.

# 9 Configure special applications

Special applications let you use the special features over the LAN such as online games, video calls, and IP calls.

1. Connect your computer to the CPE's Wi-Fi (or to the CPE's LAN port using an Ethernet cable). Enter **192.168.8.1** in the address box of the browser, and enter the login password to access the management page of the CPE.
2. Go to **Advanced > Security > Special Applications**, click **+** to access the special app configuration page, enter the **Name**, **Trigger Protocol**, **Trigger Port**, **Open Protocol**, and **Open Port**, and click **Save** to complete configuration.

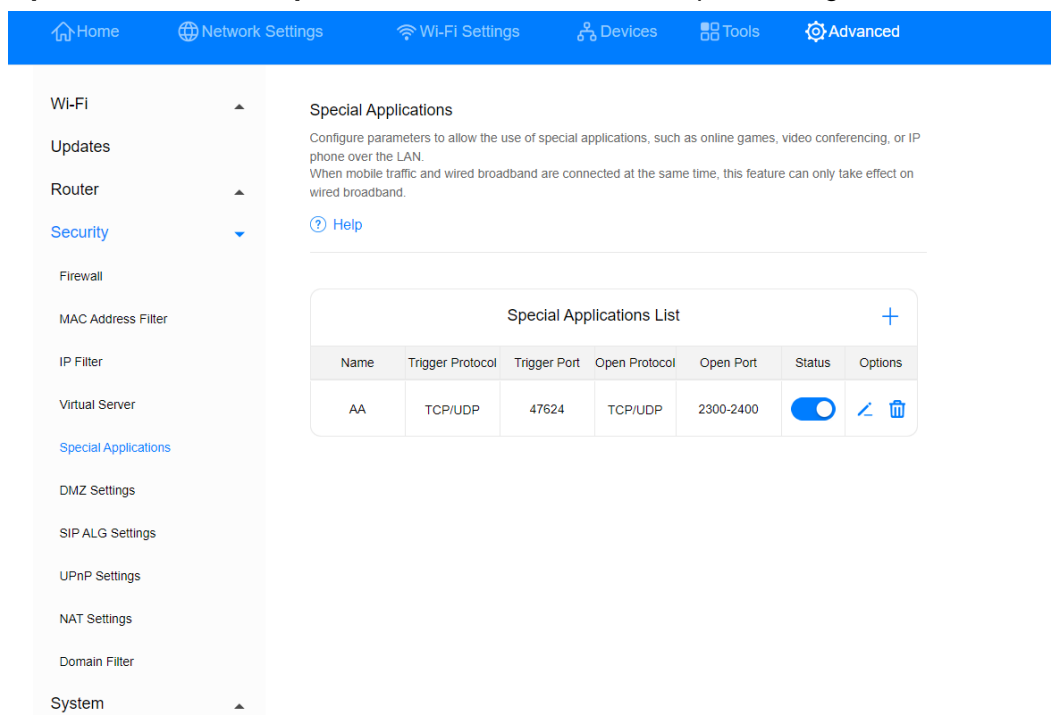

Option	Description	Mandatory or Optional
<b>Name</b>	Name of the special application to be created	Mandatory
<b>Trigger Protocol</b>	Type of the protocol used to trigger the application	Mandatory

<b>Option</b>	<b>Description</b>	<b>Mandatory or Optional</b>
<b>Trigger Port</b>	Port number for triggering applications	Mandatory
<b>Open Protocol</b>	Type of the protocol used by the open port	Mandatory
<b>Open Port</b>	When the trigger port is detected, the data packets destined for the LAN on this port are allowed to pass through the firewall so that the corresponding special application program can work normally under the NAT route.	Mandatory

 **NOTE**

- For details about the parameters, contact the corresponding application provider.
- A maximum of 16 special applications can be configured.

# 10 Enable or disable the data service

By default, the data service function is enabled for the CPE. After the CPE registers for the Internet, it automatically initiates a dial-up connection. You can manually disable this function and manually enable it when you need to access the Internet.

1. Connect your computer to the CPE's Wi-Fi (or to the CPE's LAN port using an Ethernet cable). Enter **192.168.8.1** in the address box of the browser, and enter the login password to access the management page of the CPE.
2. Go to **Network Settings > Mobile Network > Internet Connection**. Disable the **Mobile data** switch to disable the data service. In this case, the CPE will disconnect from the network.

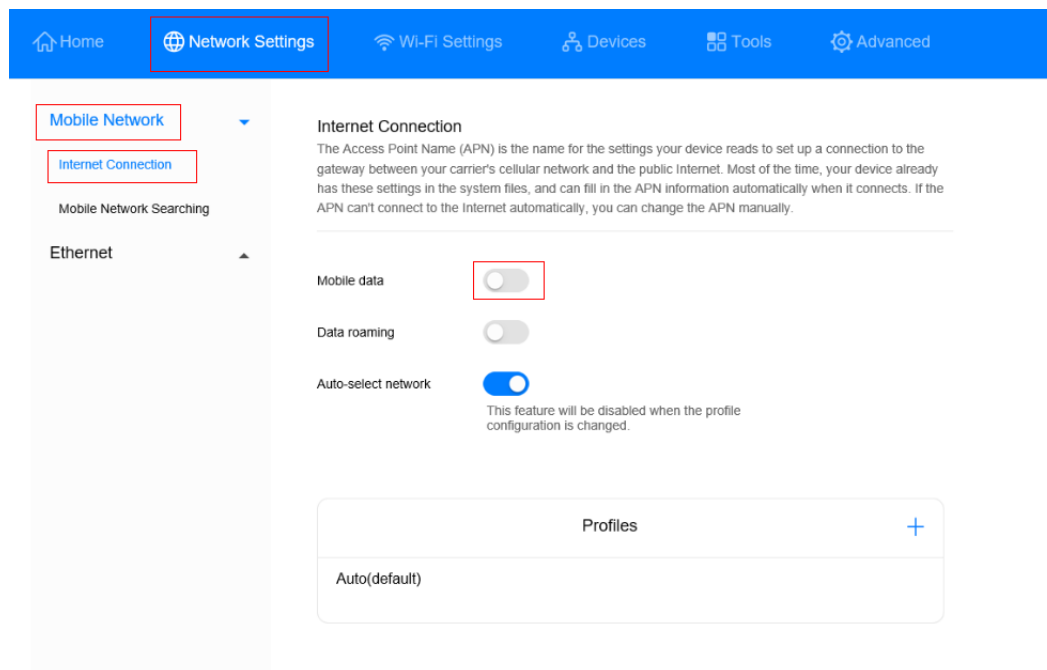

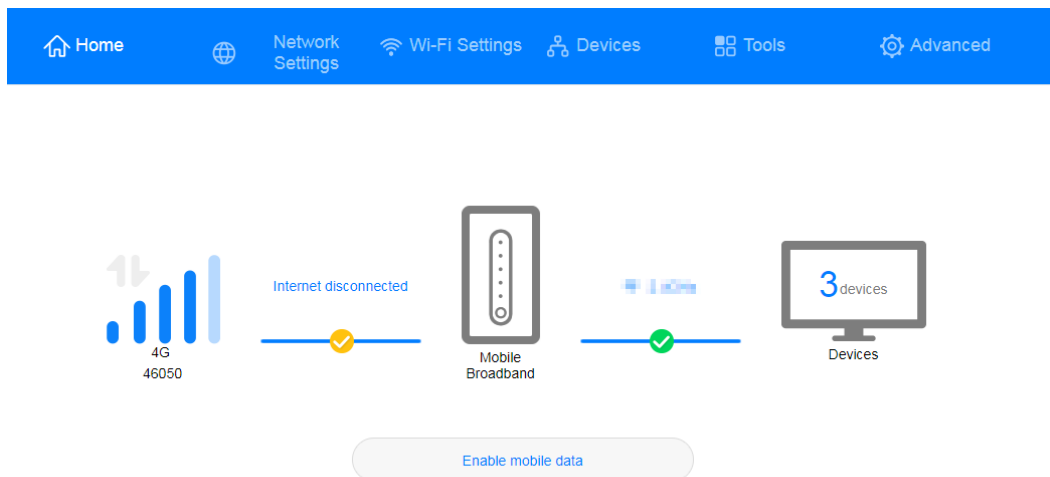

3. When you need to access the Internet, turn on the **Mobile data** switch to enable the data service. The CPE will re-initiate a dial-up connection.

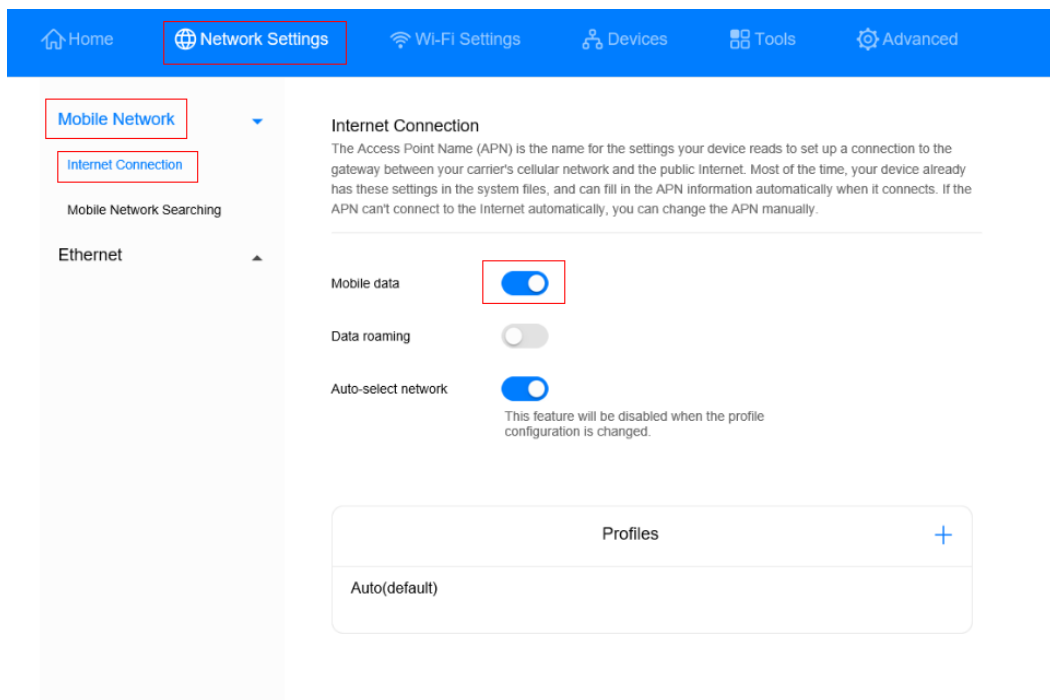



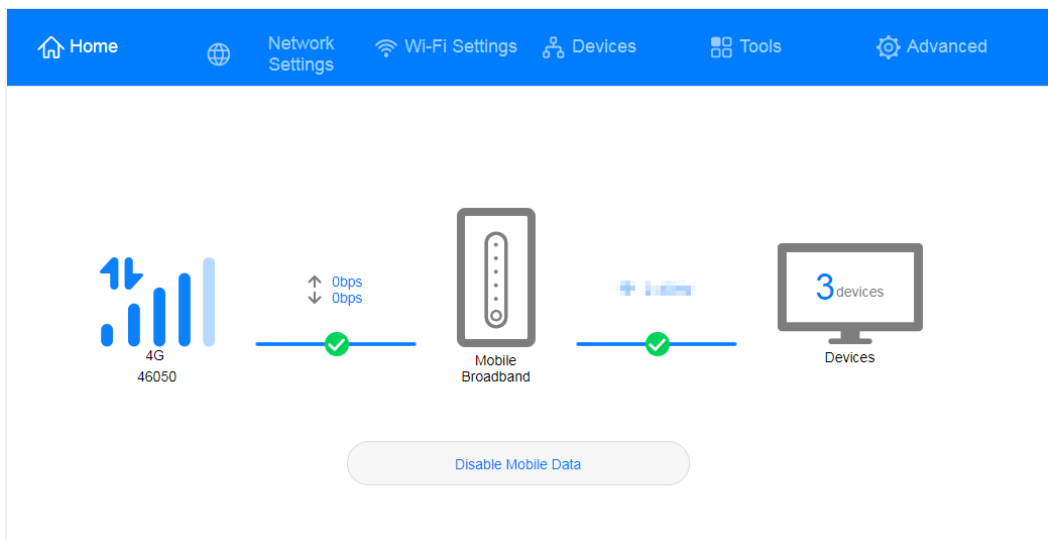

# 11 Create an APN list

Create a profile on the management page. After the CPE successfully dials up, it can connect to the Internet in wireless mode.

1. Connect your computer to the CPE's Wi-Fi (or to the CPE's LAN port using an Ethernet cable). Enter **192.168.8.1** in the address box of the browser, and enter the login password to access the management page of the CPE.
2. Go to **Network Settings > Mobile Network > Internet Connection**, and click **+**.

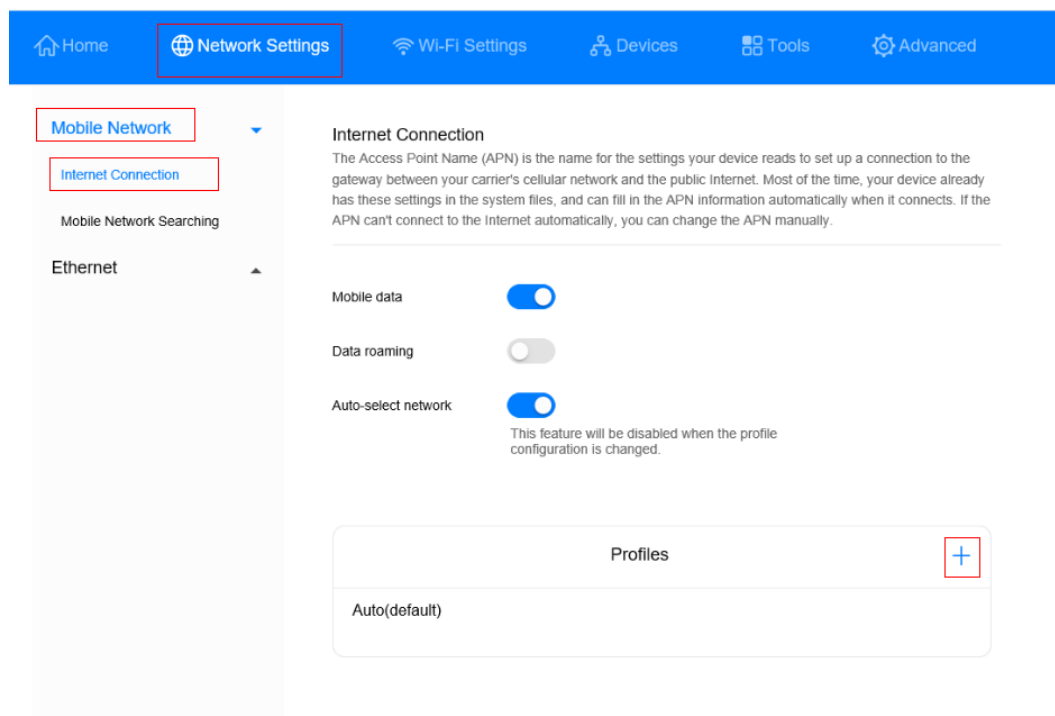

3. Set the following parameters and click **Save**.

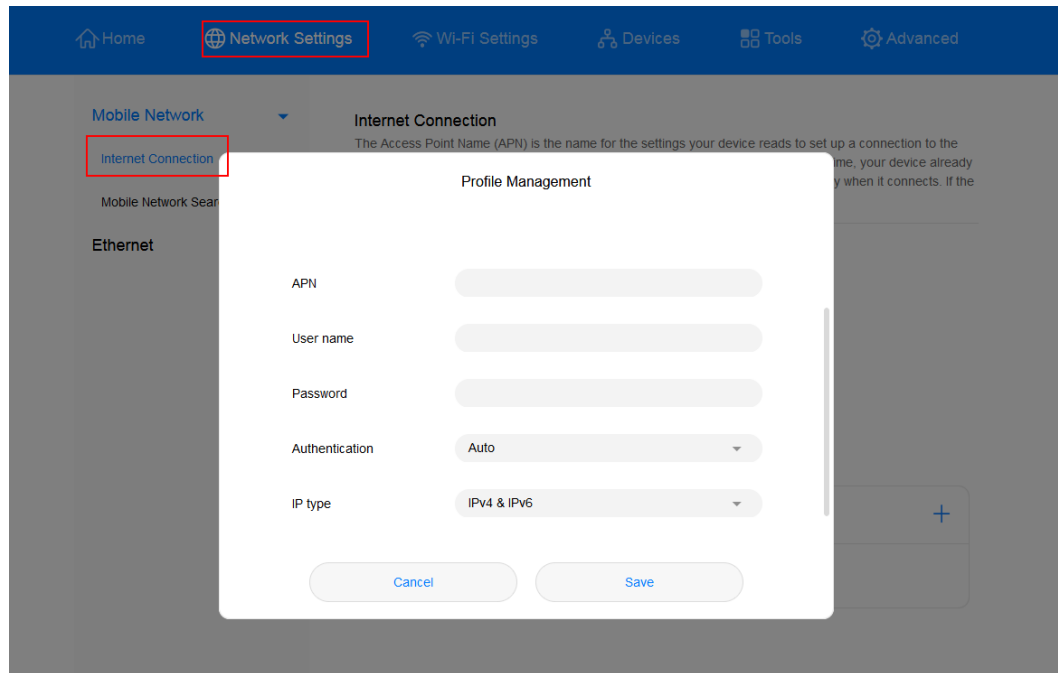

 **NOTE**

Contact the carrier to obtain the **APN**, **User name**, and **Password**.

# 12 Configure the NAT function

---

NAT is a process in which the source and destination IP addresses of an IP packet are changed when the IP packet passes through a router or firewall. The purpose of this process is to translate internal (private) IP addresses into external (public) IP addresses to prevent IP address exhaustion. The CPE supports port-restricted cone NAT and symmetric NAT. You can set NAT parameters as required.

1. Connect your computer to the CPE's Wi-Fi (or to the CPE's LAN port using an Ethernet cable). Enter **192.168.8.1** in the address box of the browser, and enter the login password to access the management page of the CPE.
2. Go to **Advanced > Security > NAT Settings**, and select **Symmetric** or **Cone**.

# 13 Configure the VPN client

---

A virtual private network (VPN) is an enterprise network established on the public network. The enterprise network has the same security, management, and functions as the private network. It can be considered as a virtual private line of an enterprise. For example, a user can connect to the intranet of the enterprise through the VPN network in another area, and the data will be encrypted.

## Prerequisites

1. Apply for an available VPN account. For details about the VPN account, contact the VPN service provider.
2. The CPE dials up successfully and can access the Internet.

## Method 1: Configuring the L2TP VPN client

1. Connect your computer or phone to the CPE's Wi-Fi (or connect your computer to the CPE's LAN port using an Ethernet cable). Enter **192.168.8.1** in the address box of the browser, and enter the login password to access the management page of the CPE.
2. Go to **Advanced > Router > VPN**.
3. Click **Enable VPN** to enable the VPN function of the router, and set **Connection type** to **L2TP VPN client**.

**NOTE**

1. The parameter values in the following figure are for reference only. Set the parameters based on the actual VPN account.
2. When L2TP is used for VPN dial-up, the entered parameters must be the VPN server parameters of the L2TP type. Otherwise, the dial-up will fail.

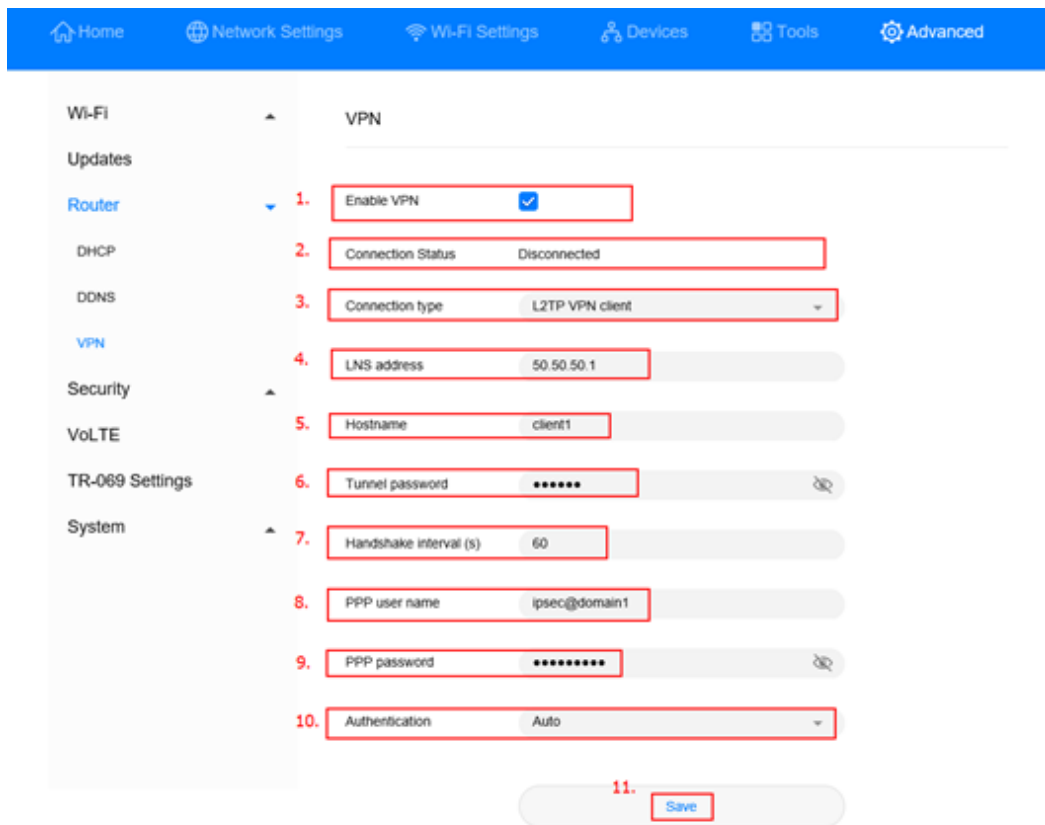

Option	Description	Mandatory or Optional
<b>LNS address</b>	IP address or domain name of the L2TP server	Mandatory
<b>Hostname</b>	Host name of the L2TP server <b>NOTE</b> If the server does not have a host name, enter any value. If the server requires host name verification, the entered host name must be correct. For details, see the VPN account that has been applied for.	Optional
<b>Tunnel password</b>	Tunnel password of the L2TP server <b>NOTE</b> If the server does not have a tunnel password, enter any value. If the server requires tunnel password verification, the entered tunnel password must be correct. For details, see the VPN account that has been applied for.	Optional
<b>PPP user name</b>	User name of the L2TP server	Mandatory
<b>PPP</b>	Password of the L2TP server	Mandatory

Option	Description	Mandatory or Optional
password		

- Click **Save**. If the **Connection Status** is **Connected**, it indicates that the VPN is successfully connected.

## Method 2: Configuring the PPTP VPN client

- Connect your computer or phone to the CPE's Wi-Fi (or connect your computer to the CPE's LAN port using an Ethernet cable). Enter **192.168.8.1** in the address box of the browser, and enter the login password to access the management page of the CPE.
- Go to **Advanced > Router > VPN**.
- Click **Enable VPN** to enable the VPN function of the router, and set **Connection type** to **PPTP VPN client**.

### NOTE

When PPTP is used for VPN dial-up, the entered parameters must be the VPN server parameters of the PPTP type. Otherwise, the dial-up will fail.

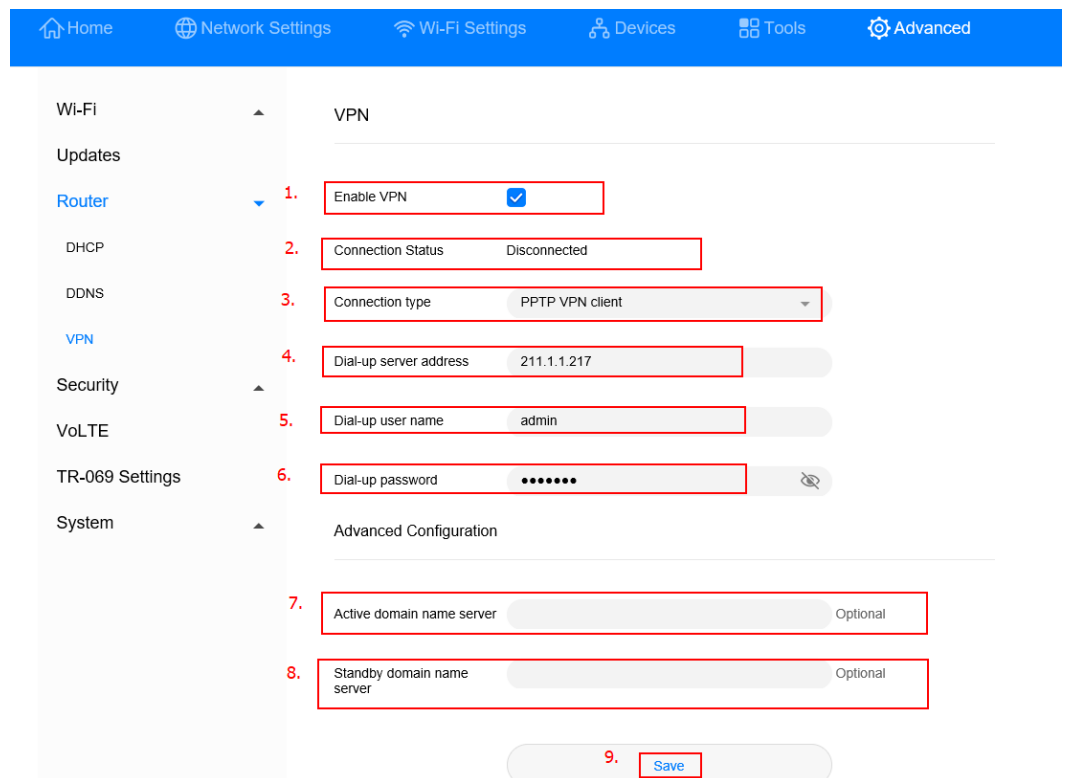

Option	Description	Mandatory or Optional
<b>Dial-up server address</b>	IP address or domain name of the PPTP server	Mandatory

Option	Description	Mandatory or Optional
<b>Dial-up user name</b>	Dial-up user name of the PPTP server	Mandatory
<b>Dial-up password</b>	Dial-up password of the PPTP server	Mandatory
<b>Active domain name server</b>	IP address of the primary DNS server of the PPTP server	Optional
<b>Standby domain name server</b>	IP address of the standby DNS server of the PPTP server	Optional

4. Click **Save**. If the **Connection Status** is **Connected**, it indicates that the VPN is successfully connected.



# 14 Modify the Wi-Fi name and password

1. Connect your computer to the CPE's Wi-Fi (or to the CPE's LAN port using an Ethernet cable). Enter **192.168.8.1** in the address box of the browser, and enter the login password to access the management page of the CPE.
2. Go to **Wi-Fi Settings > Wi-Fi Basic Settings** to view the current Wi-Fi name and password. Enter the new **Wi-Fi name (SSID)** and **Wi-Fi password**, and click **Save**.

The screenshot displays the 'Wi-Fi Basic Settings' page. At the top, a blue navigation bar contains icons for Home, Network Settings, Wi-Fi Settings (highlighted with a red box), Devices, Tools, and Advanced. Below this, a sidebar on the left shows 'Wi-Fi Basic Settings' (highlighted with a red box) under the 'Guest Wi-Fi' section. The main content area is titled 'Wi-Fi Basic Settings' and features a 'Wi-Fi' toggle switch that is turned on. Below the toggle are three input fields: 'Wi-Fi name (SSID)' with the value 'HUAWEI-B019-GA01', 'Security mode' with a dropdown arrow, and 'Wi-Fi password' with a masked password and a password icon. A 'Save' button (highlighted with a red box) is positioned below these fields, with a 'More Wi-Fi Settings' link underneath it.

# 15 Set the Wi-Fi blocklist and trustlist

After Wi-Fi access control is enabled, you can set the Wi-Fi of the CPE to blocklist mode or trustlist mode as required. In blocklist mode, devices in the blocklist cannot connect to the CPE. In trustlist mode, only devices in the trustlist can connect to the CPE. Setting the Wi-Fi blocklist and trustlist enhances network security. The CPE can restrict user access even if someone knows your Wi-Fi name and password.

1. Connect your computer to the CPE's Wi-Fi (or to the CPE's LAN port using an Ethernet cable). Enter **192.168.8.1** in the address box of the browser, and enter the login password to access the management page of the CPE.
2. Go to **Advanced > Wi-Fi > Wi-Fi MAC Filter**. Enable **Wi-Fi MAC Filter**. Set the CPE to blocklist mode (**Block** the access of devices in the list) or trustlist mode (**Allow** the access of devices in the list) as required.
3. Set **Filter mode** to **Block** or **Allow**, and click **+** to add Wi-Fi devices to the Wi-Fi MAC address list. Then click **Save**.

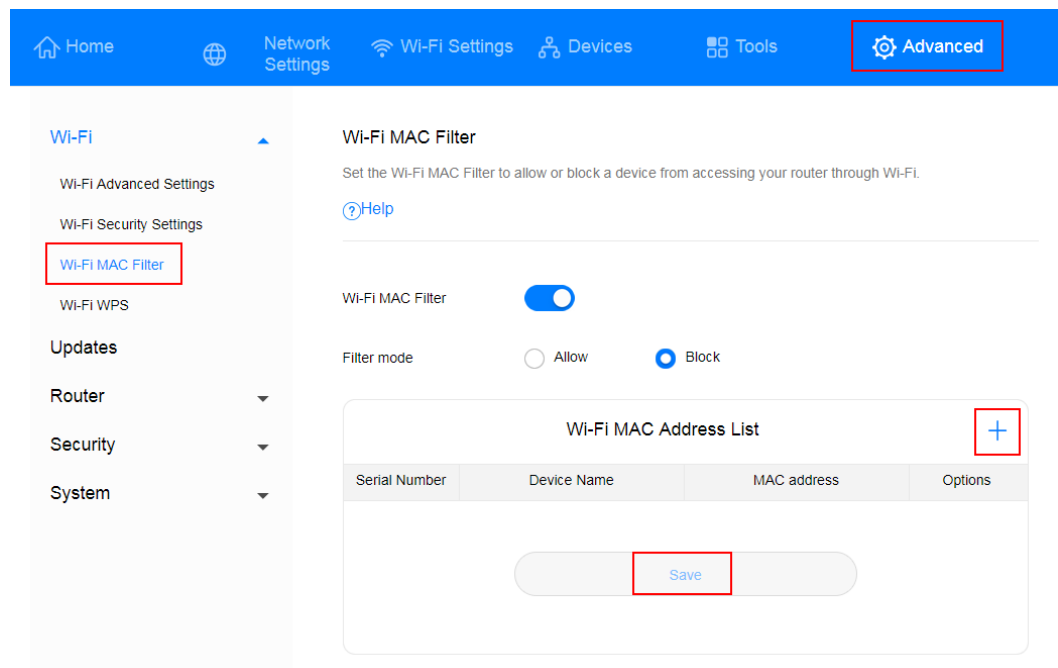

## NOTE

After the devices are added, you can view them in the Wi-Fi MAC address list.

If you do not want to use the blocklist or trustlist function, disable **Wi-Fi MAC Filter**.

# 16 Set parental controls

The CPE supports the parental control feature to control the network access permission of devices.

1. Connect your computer to the CPE's Wi-Fi (or to the CPE's LAN port using an Ethernet cable). Enter **192.168.8.1** in the address box of the browser, and enter the login password to access the management page of the CPE.
2. Go to **Tools > Parental Control**, and click **+**.

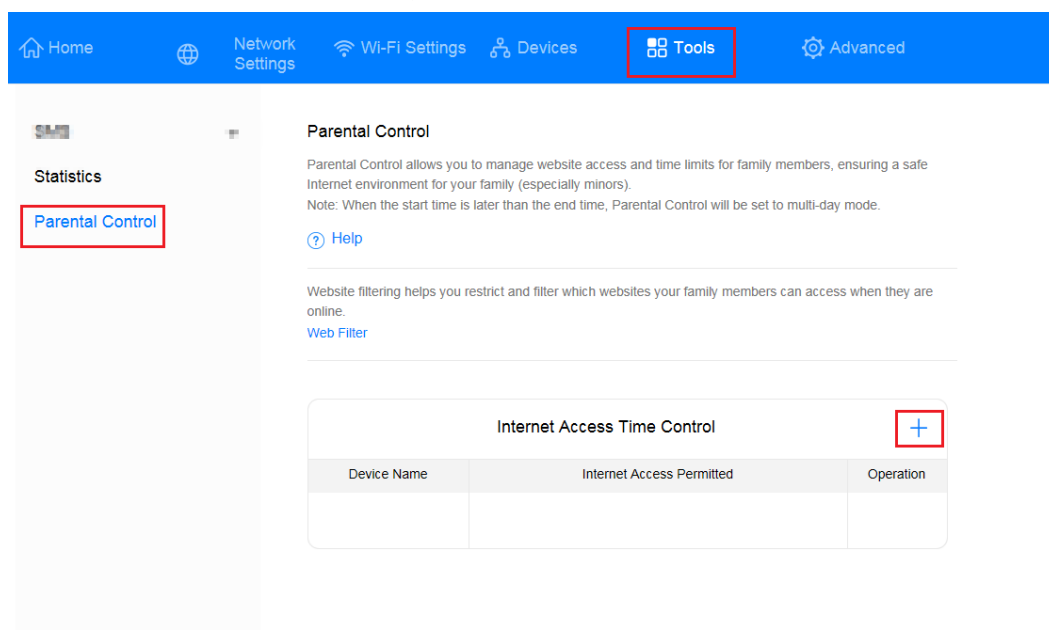

3. Select the desired time period, week, and device (displayed as a device name), and click **Confirm**.

Internet Access Time Control

---

Time 02 : 00 to 03 : 00

Repeats  Mon  Tue  Wed  Thu  Fri  Sat

Sun

Enable on selected devices

Honor\_7X(B0:E1:7E:37:7C:FC)

A171215943K(F8:94:C2:D4:F0:B2)

W00342864-ZR(00:E0:4C:22:15:30)[This device]

BA04840868-A(EC:17:2F:FD:43:9F)

CancelConfirm